

A	B	C	D	
1	S332-0020	546	198	6/6
2	S332-0024	546	198	6/6
3	S332-0025	600	546	6/6
4	S332-1031	1900	400	1/6
5	S332-1032	1900	400	1/6
6	S332-2003	582	400	2/6
7	S332-3006	551	382	2/6
8	S332-3027	550	354	2/6
9	S332-3028	551	366	2/6
10	S332-5001	120	50	2/6
11	S332-5002	120	50	2/6
12	S332-5003	120	50	2/6
13	S332-5012	980	545	4/6
14	S332-5013	549	330	3/6
15	S332-9308	1895	561	1/6

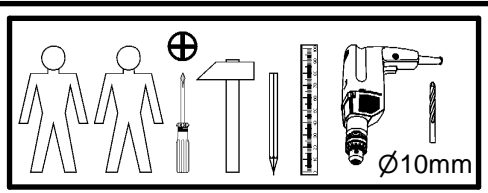

4x K16: 436 a101	4x b59	2x 128 mm c424	8x d1 Ø5x17 mm	8x d3 Ø5x17 mm	8x e31 Ø6x22 mm	10x e41 Ø5x12 mm	12x f1 Ø8x30 mm	4x M4x22 mm j30	
10x l1	12x l2	10x o54 Ø5,3/Ø8,3x4,8 mm	2x o57/1	1x o57/2	1x o57/3	8x p51 Ø3,5x15 mm	12x r1 Ø15x12 mm #16	12x 20/11 r42	
4x s2 Ø16	1x n26/1	1x p38 Ø3,5x16 mm							

1 

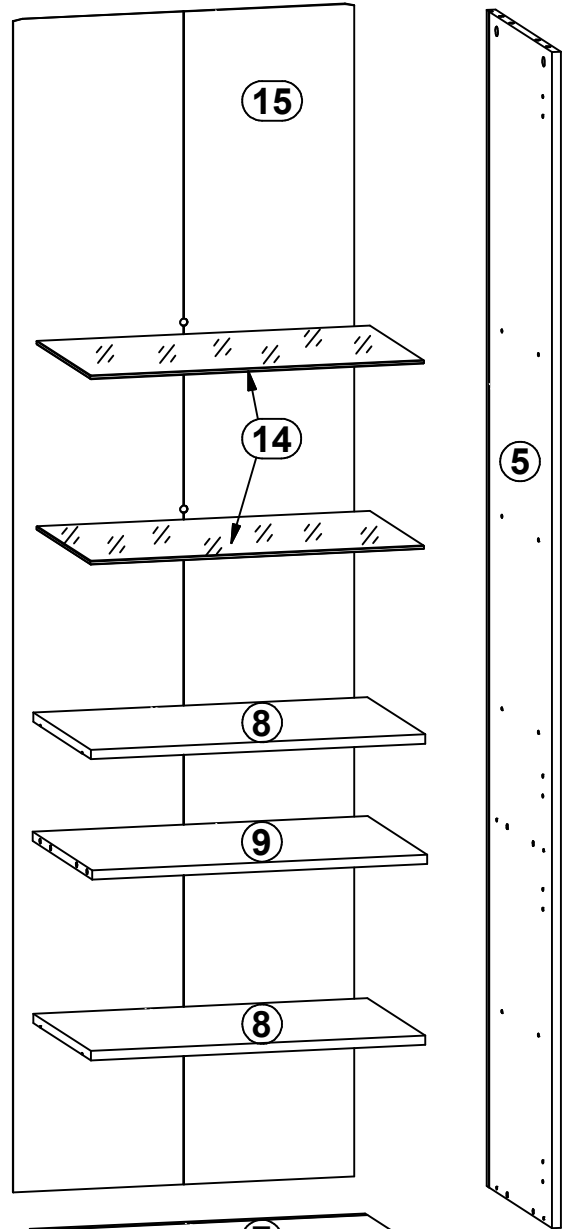
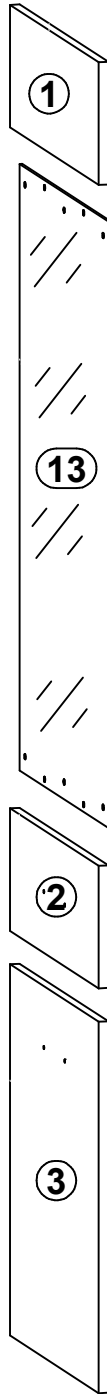
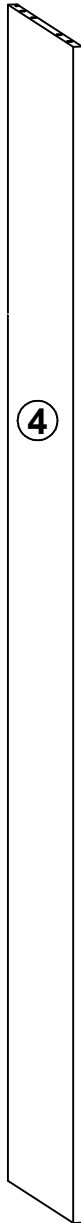
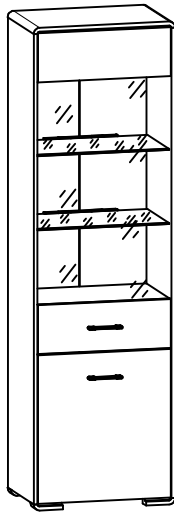
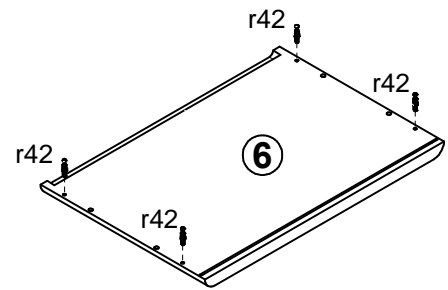
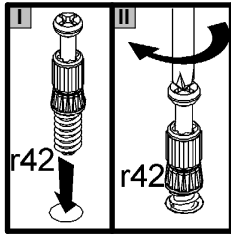
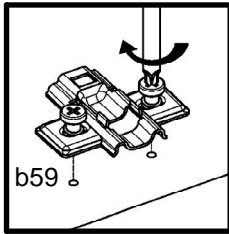
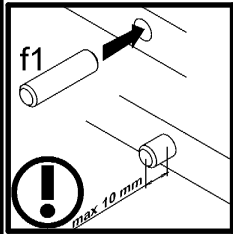
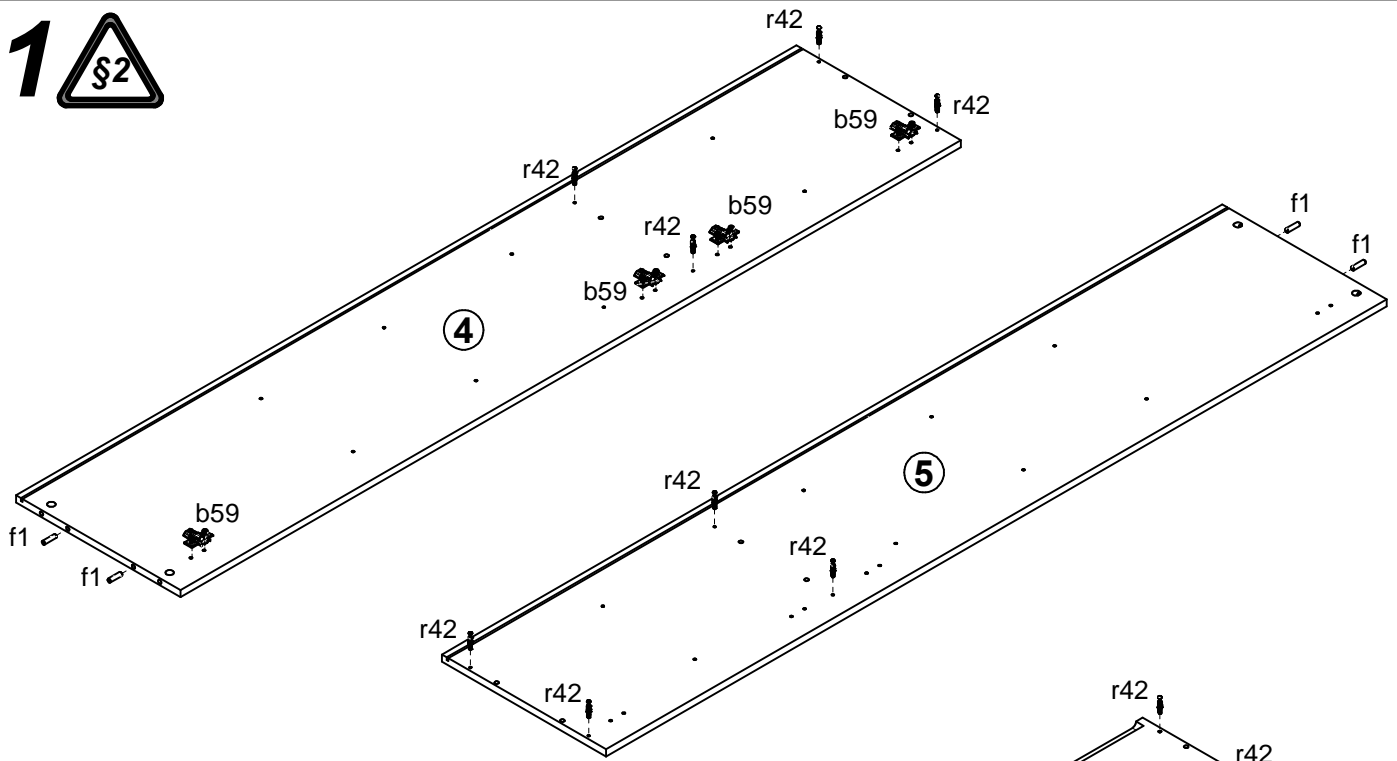

2 

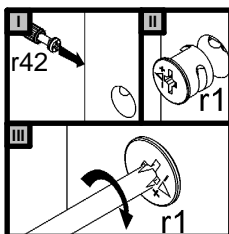
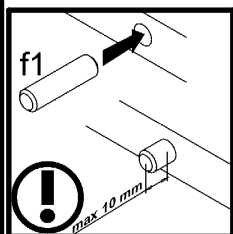
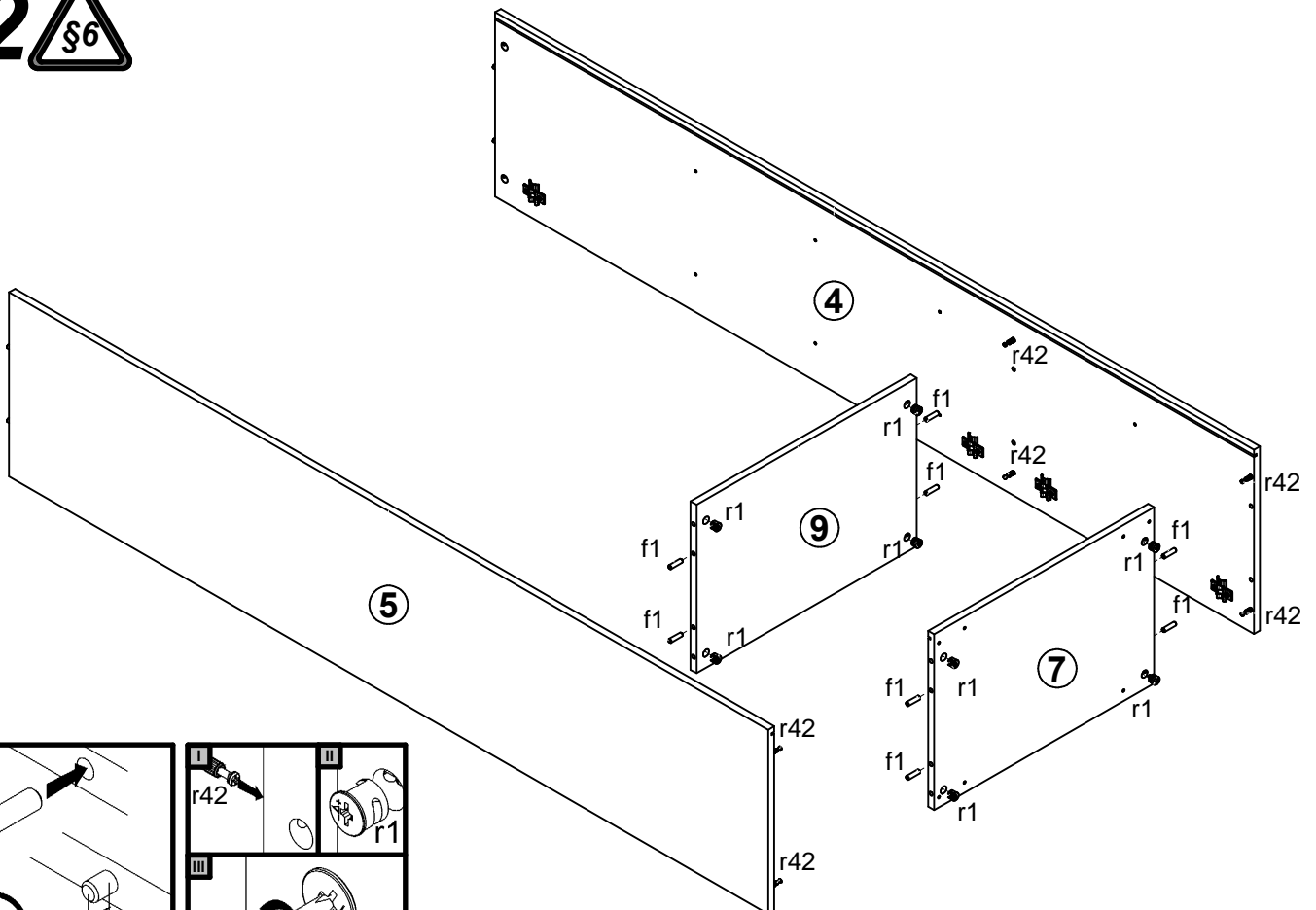

3

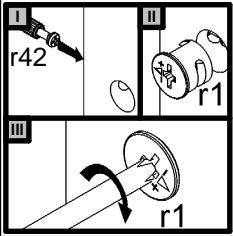
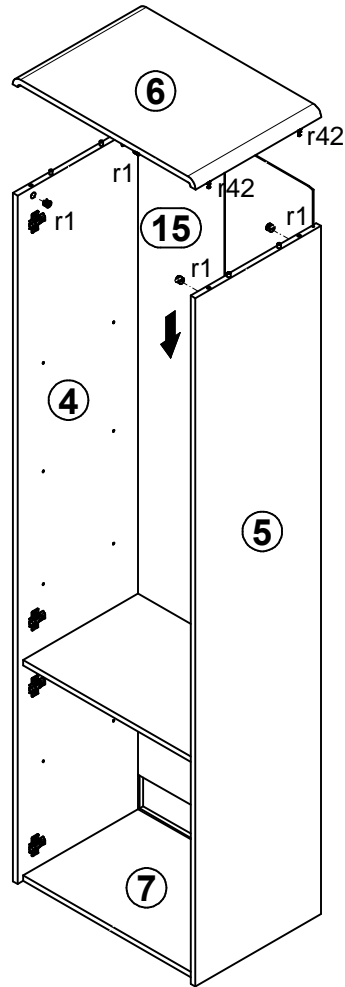

4

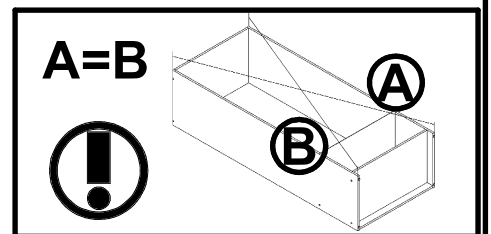
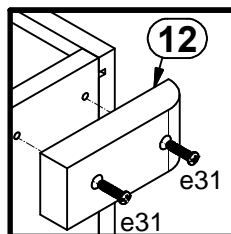
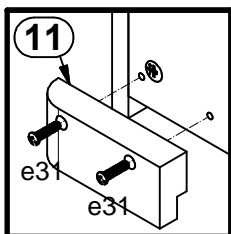
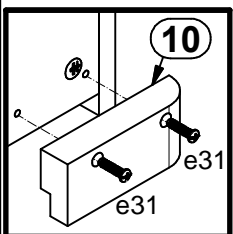
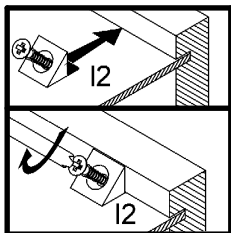
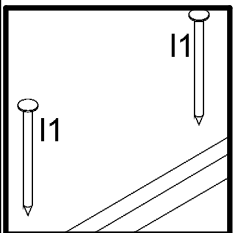
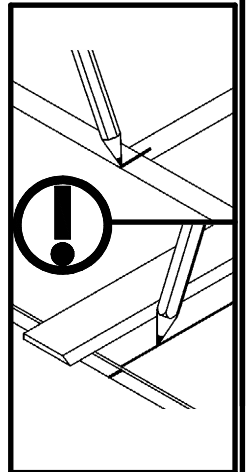
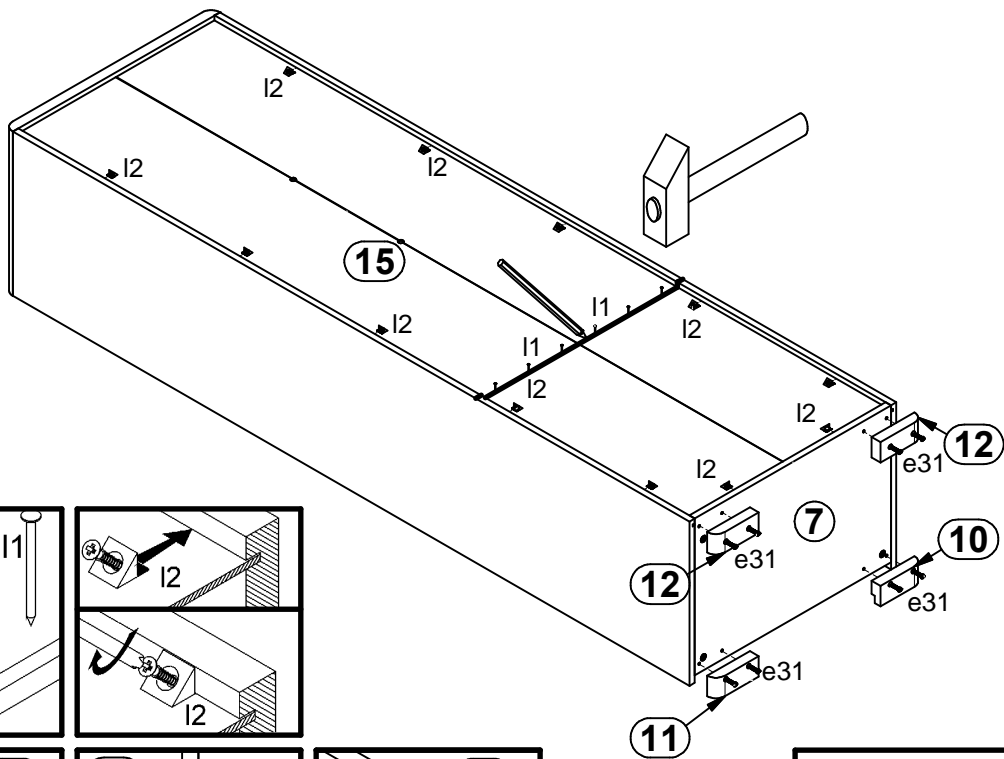

5 

A=B

(A) **(B)**

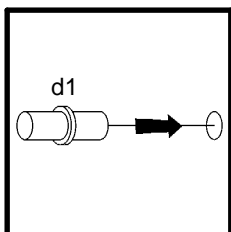
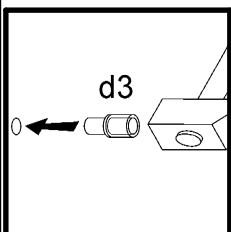
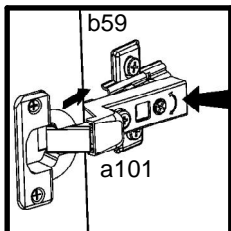
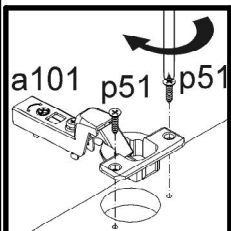
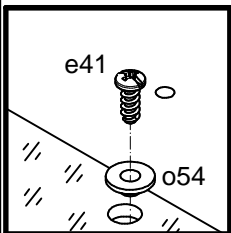
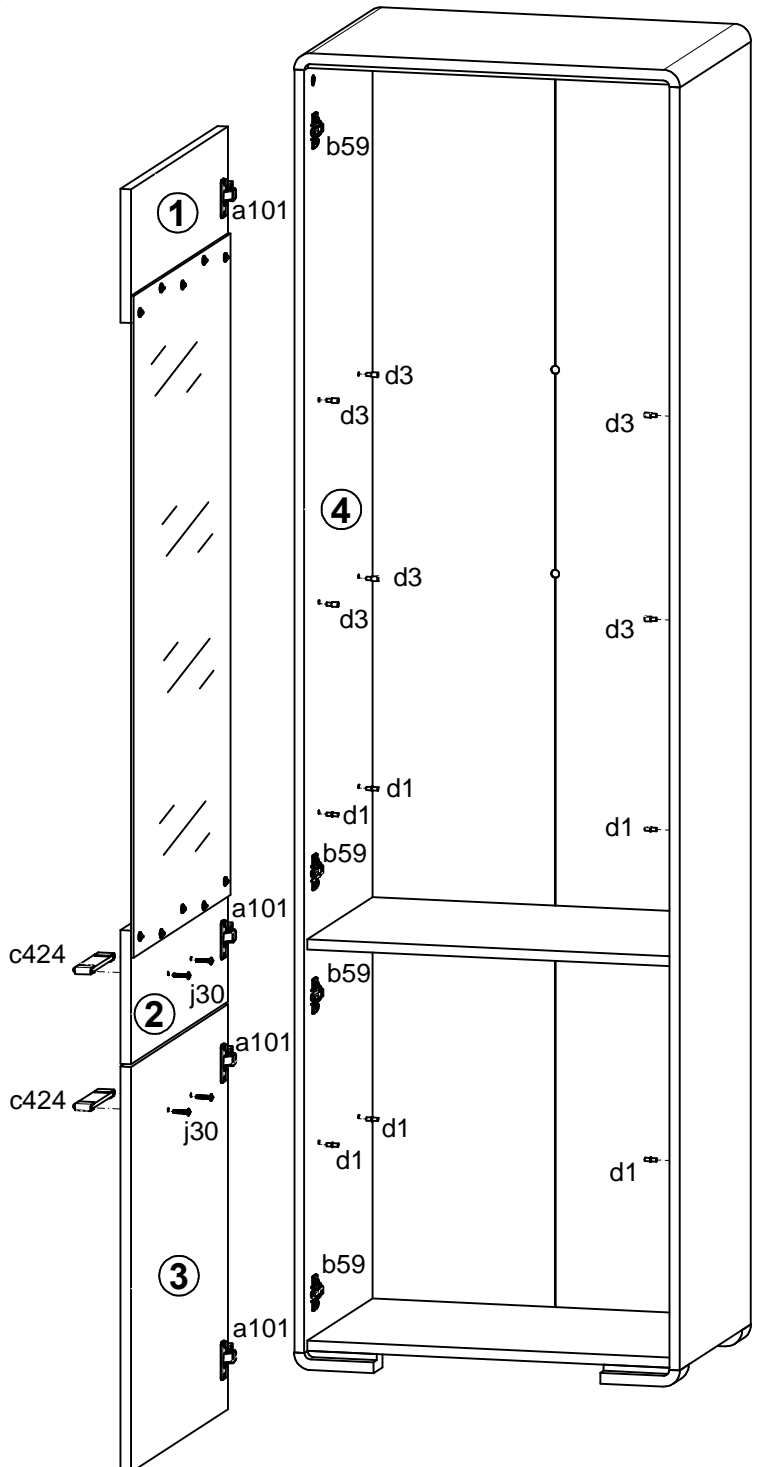
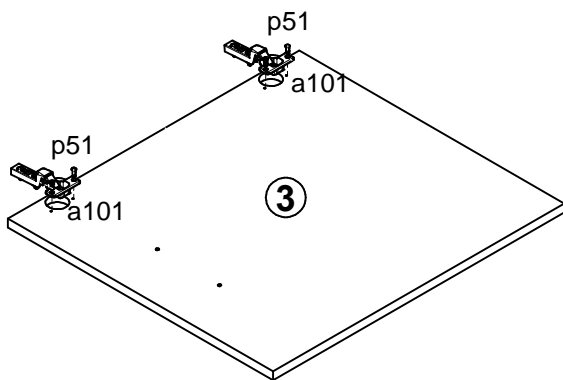
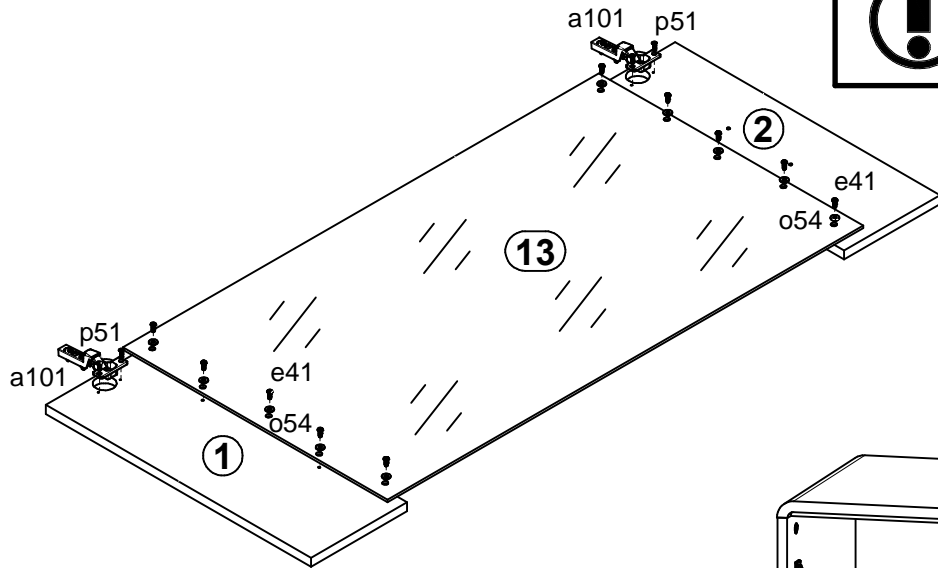
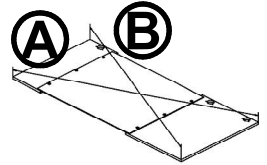

6

